

INSTRUCTIONS INSTALLATION OF PEDESTAL FOR VLT DRIVES

This instruction sheet is for the installation of a pedestal unit available for the VLT series drive frames D1 and D2. This is a 200mm high pedestal that allows these frames to be floor mounted. The front of the pedestal has openings for input air to the power components.

The drive gland plate must be installed to provide adequate cooling air to the control components of the drive via the drive door fan and to maintain the IP21/NEMA1 or IP54/NEMA12 degrees of enclosure protection.

This pedestal applies to the VLT4000, VLT5000, VLT6000, VLT8000, Tier 2 and 3 APU, VLT-HVAC, VLT-AQUA and VLT-Automation drives.

There is one pedestal that fits both Frame D1 and Frame D2.

Ordering number: 176F1827

Tier 2 APUs—order two kits
Tier 3 APUs—order three kits

Kit Contents

- Pedestal parts
 - Primary pedestal frame
 - Vented front cover
 - Two side covers
 - Two front brackets
 - Hardware for assembly
- Instruction manual

Required Tools

- Socket wrench with 07mm to 17mm sockets
- T30 Torx Driver

Torque Requirements

M6 — 35 in-lbs (4.0 N-M)
M8 — 85 in-lbs (9.8 N-M)
M10 — 170 in-lbs(19.6 N-M)



Photo 1. Frame D2 with pedestal



Photo 2. Tier 3 Frame D2 APU with pedestal

The kit contains the primary pedestal frame, a vented front cover, 2– side covers, two front brackets and the required hardware for assembly.

Refer to drawing 175R5641 for an exploded view of the installation.

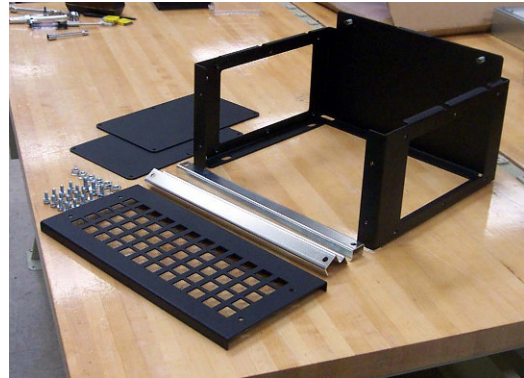

Photo 2. Pedestal Parts

Shown in Photo 3 is a partially assembled pedestal. Before installing the drive on to the pedestal, the pedestal must be anchored to the floor using the four pedestal mounting holes. The holes can accommodate up to M12 bolts (not included in kit)

CAUTION: The drives are top heavy and may fall over if the pedestal is not anchored to the floor.

The entire assembly may also be supported by using the drive top mounting holes to anchor to a wall structure.

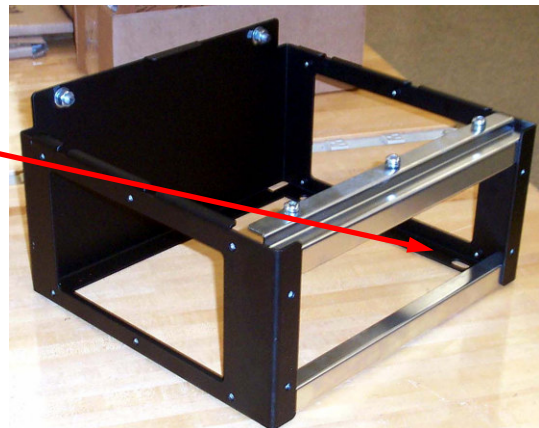

Photo 3. Partially assembled pedestal

The completely assembled pedestal with vented front cover and two side covers installed is shown in Photo 4. Multiple drives may be mounted side-by-side. The interior side plates are left off when installing drives side-by-side.

Note: The front and side cover mounting screws are recessed M6 Torx socket flat head screws.

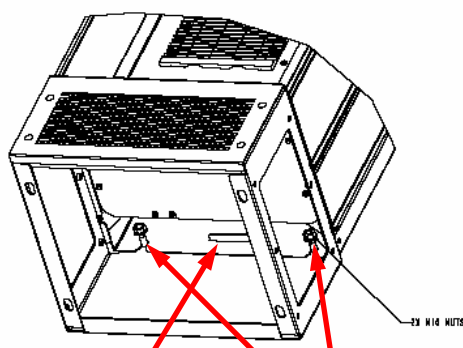
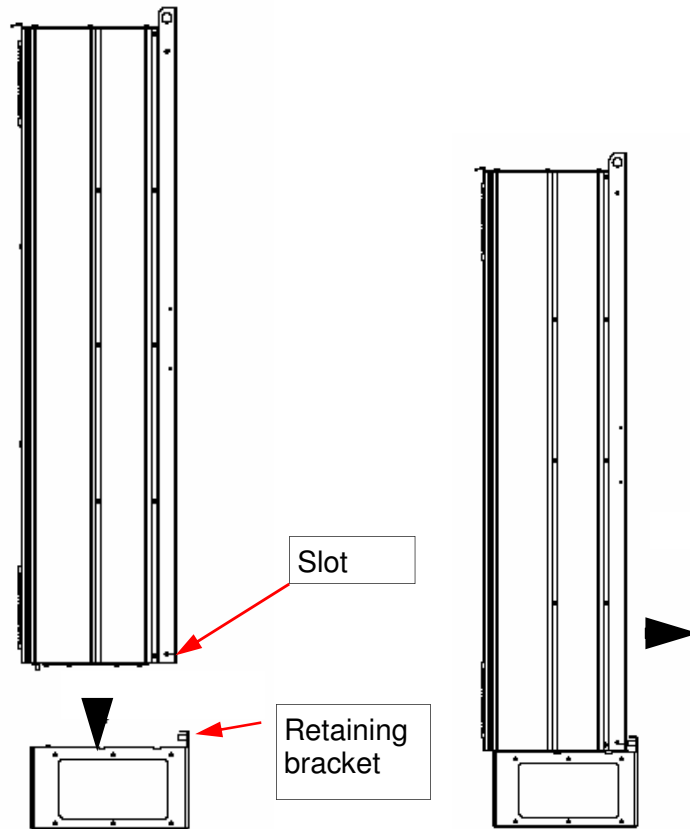

Photo 4. Completely assembled pedestal

Install drive by lowering it on to the pedestal. The drive must initially overhang the front of the pedestal to clear the retaining bracket on the rear of the pedestal. After the drive is on the pedestal, slide the drive to the rear until the slot in the drive engages the retaining bracket on the pedestal.

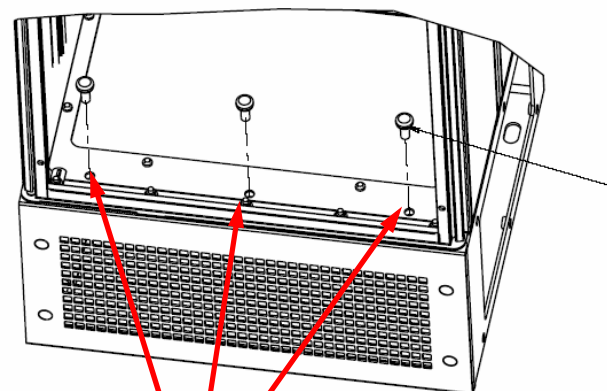

Photo 5. Frame D2 installed on pedestal.



Retaining bracket

Secure the back of drive with two M10 nuts



Secure the front of the drive to the pedestal with three M8 screws.

Danfoss High Power Drives



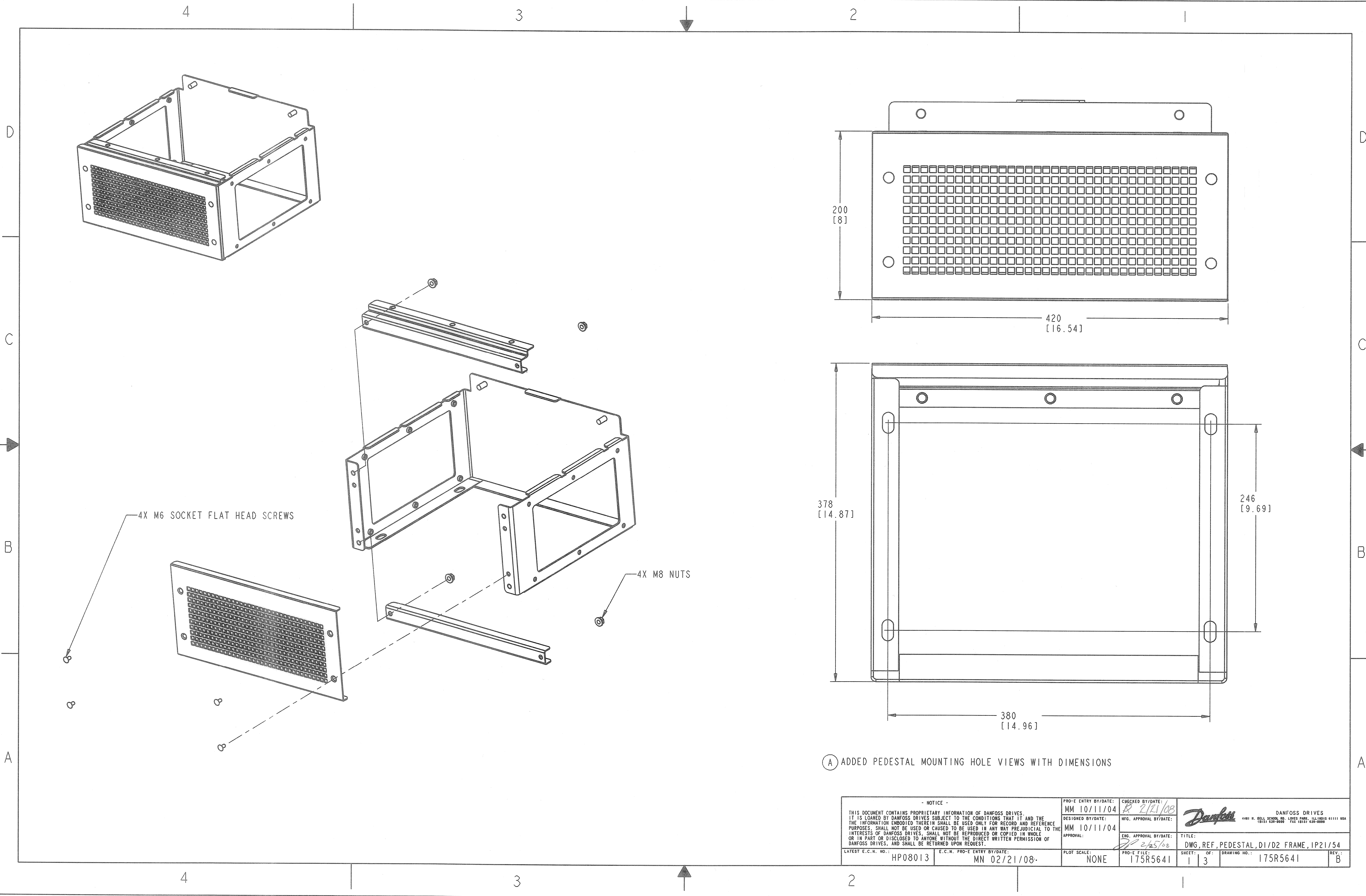

4X M6 SOCKET FLAT HEAD SCREWS

4X M8 NUTS

(A) ADDED PEDESTAL MOUNTING HOLE VIEWS WITH DIMENSIONS

- NOTICE -		PRO-E ENTRY BY/DATE: MM 10/11/04	CHECKED BY/DATE: R 2/21/08	Danfoss DANFOSS DRIVES 4401 N. BELL SCHOOL RD. LOUIS PARK, ILLINOIS 61111 USA 1815 630-8400 FAX 1815 630-8000
THIS DOCUMENT CONTAINS PROPRIETARY INFORMATION OF DANFOSS DRIVES. IT IS LOANED BY DANFOSS DRIVES SUBJECT TO THE CONDITIONS THAT IT AND THE INFORMATION EMBODIED THEREIN SHALL BE USED ONLY FOR RECORD AND REFERENCE PURPOSES. SHALL NOT BE USED OR CAUSED TO BE USED IN ANY WAY PREJUDICIAL TO THE INTERESTS OF DANFOSS DRIVES. SHALL NOT BE REPRODUCED OR COPIED IN WHOLE OR IN PART OR DISCLOSED TO ANYONE WITHOUT THE DIRECT WRITTEN PERMISSION OF DANFOSS DRIVES. AND SHALL BE RETURNED UPON REQUEST.		DESIGNED BY/DATE: MM 10/11/04	MFG. APPROVAL BY/DATE:	
LATEST E.C.N. NO.: HP08013	E.C.N. PRO-E ENTRY BY/DATE: MN 02/21/08	APPROVAL:	ENG. APPROVAL BY/DATE: 2/25/08	TITLE: DWG, REF, PEDESTAL, D1/D2 FRAME, 1P21/54
		PLOT SCALE: NONE	PRO-E FILE: 175R5641	SHEET: OF: 1 3 DRAWING NO.: 175R5641
				REV.: B

4

3

2

1

D

D

C

C

B

B

A

A

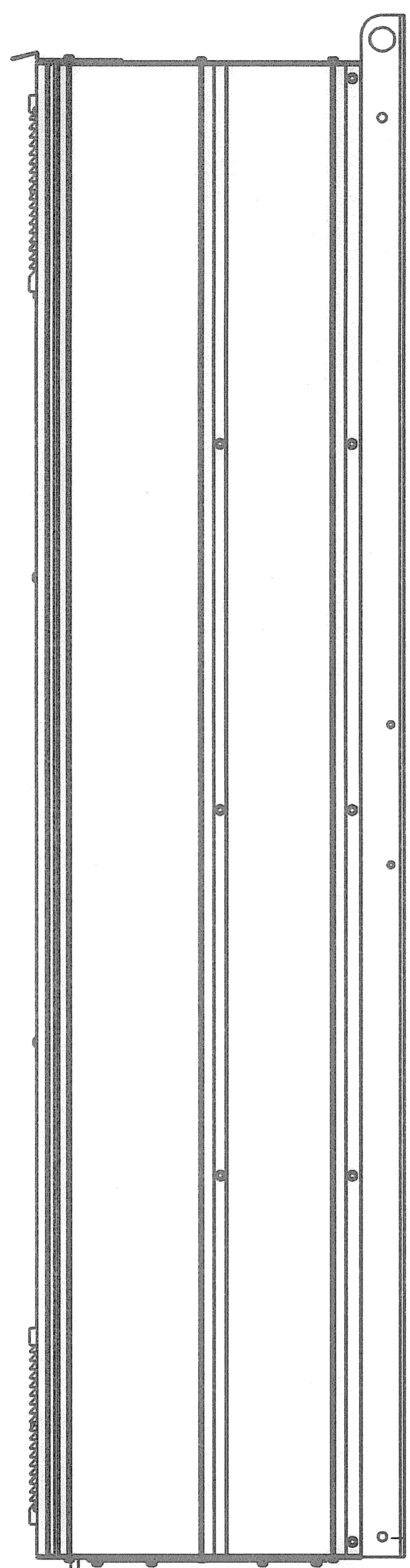

1ST MOUNTING DIRECTION

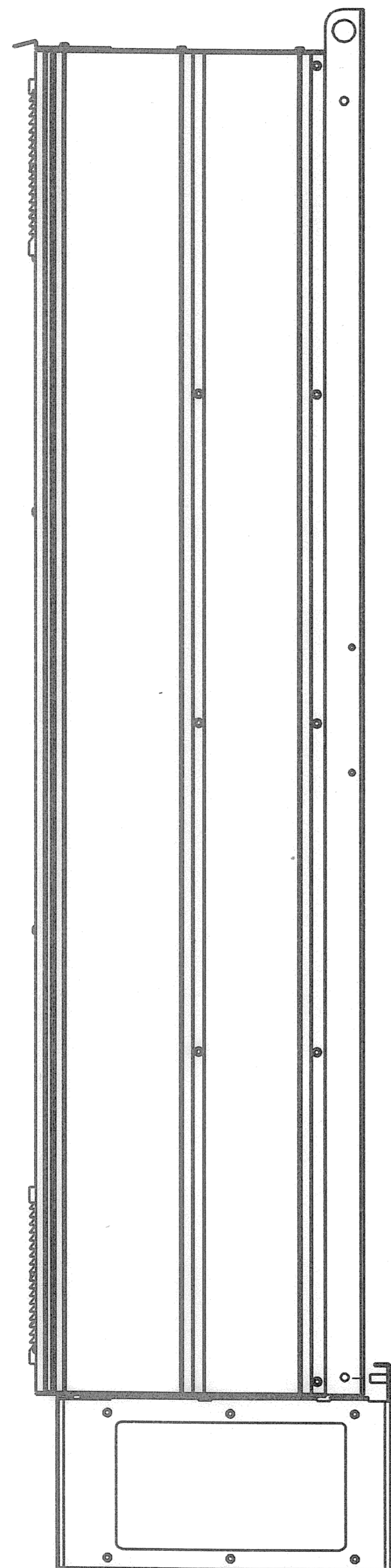
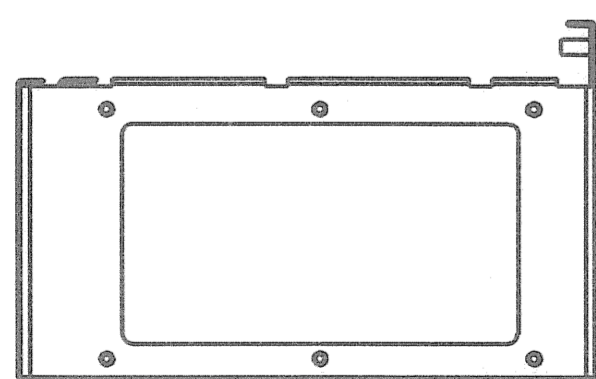

2ND MOVEMENT DIRECTION

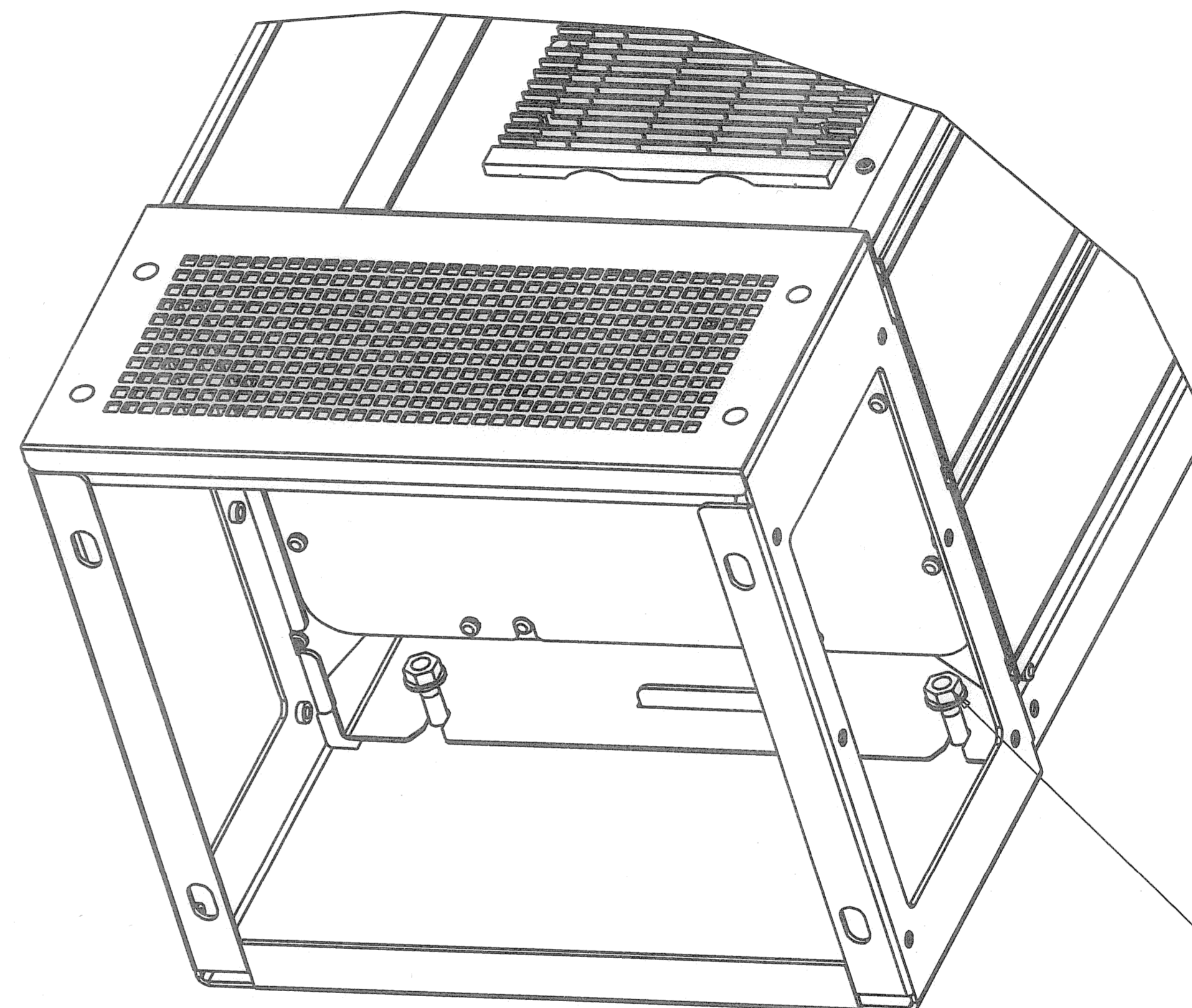

2X M10 NUTS

LATEST E.C.N. NO.:	E.C.N. PRO-E ENTRY BY/DATE:	PLOT SCALE:	PRO-E FILE:	SHEET:	OF:	DRAWING NO.:	REV.:
HP08013	MN 02/21/08	NONE	175R5641	2	3	175R5641	B

TITLE: DWG, REF, PEDESTAL, D1/D2 FRAME, IP21/54

4

3

2

1

4

3

2

1

D

D

C

C

B

B

A

A

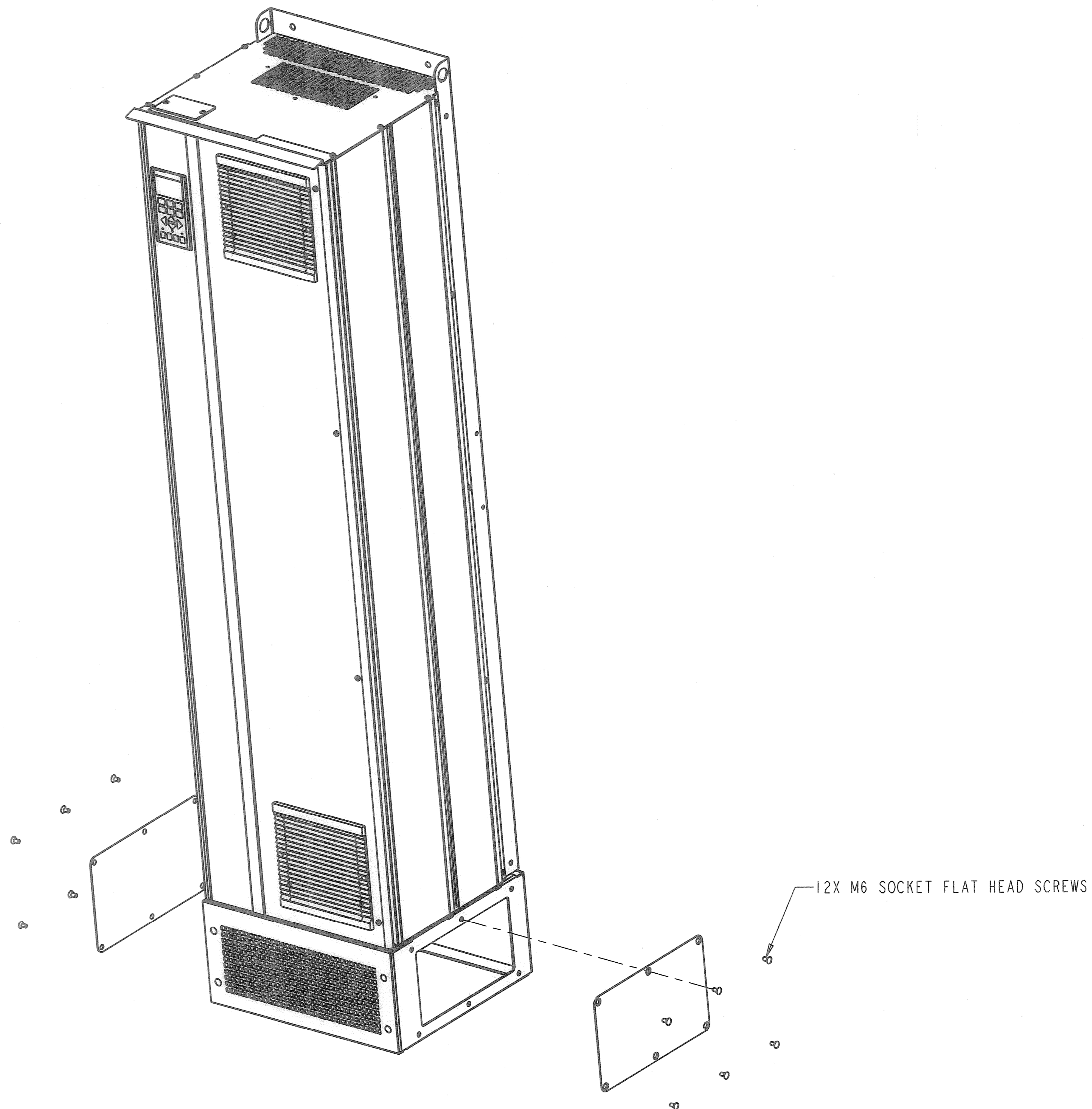
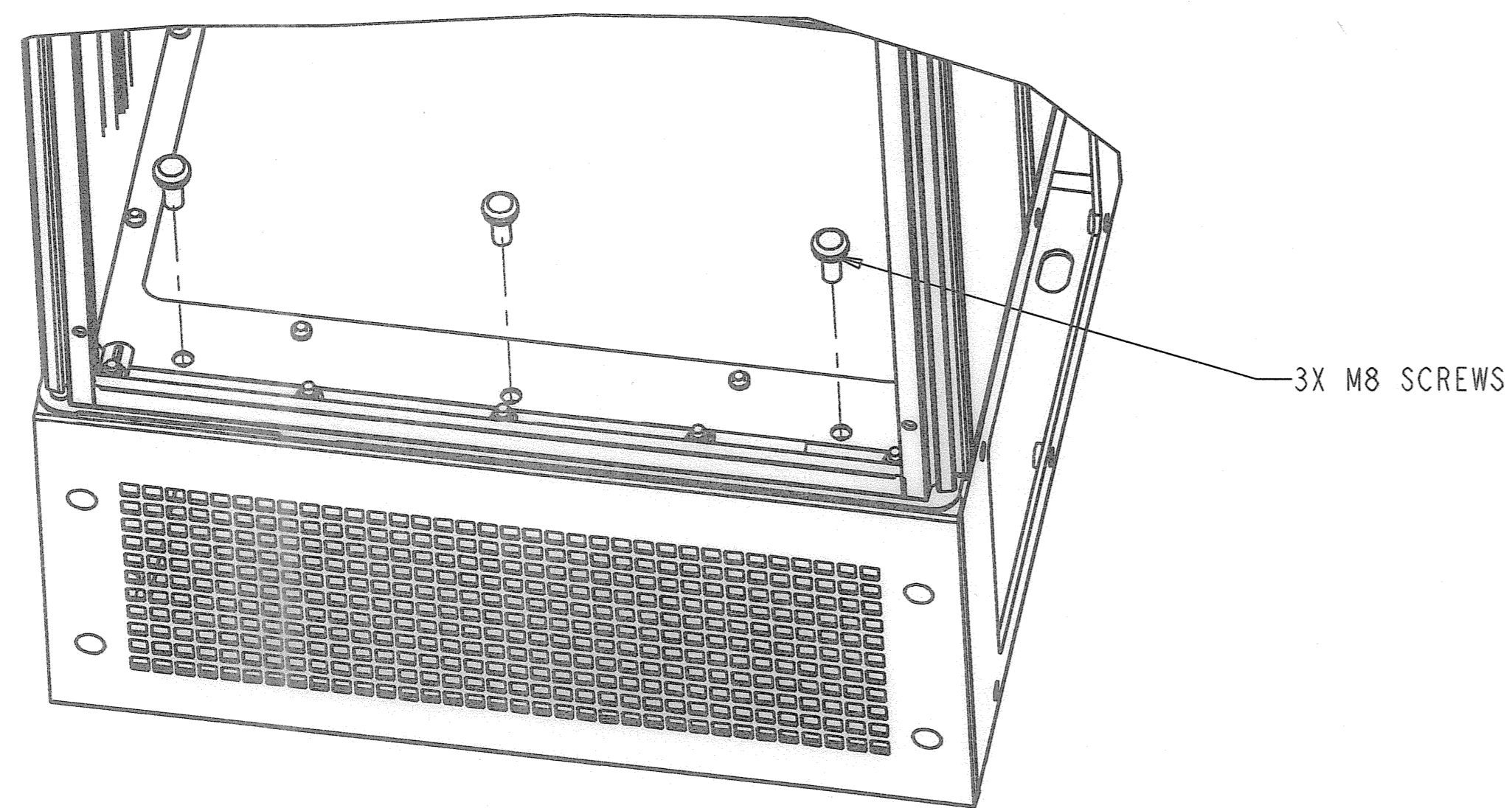

LATEST E.C.N. NO.: HP08013		E.C.N. PRO-E ENTRY BY/DATE: MN 02/21/08		PLOT SCALE: NONE		PRO-E FILE: 175R5641		SHEET: OF: 3 3		DRAWING NO.: 175R5641		REV.: B	
TITLE: DWG, REF, PEDESTAL, D1/D2 FRAME, IP21/54													

4

3

2

1